

UPPER SUSPENSIONS SMALL & LARGE FRAME

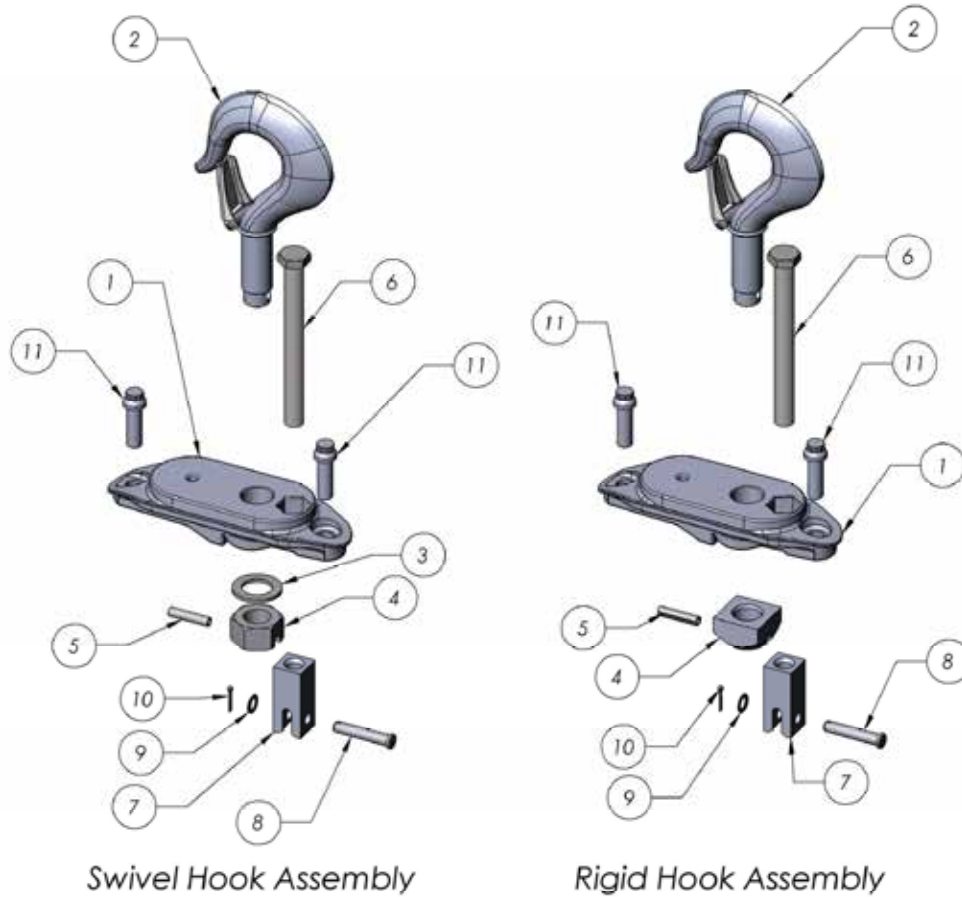

Swivel Hook Assembly

Rigid Hook Assembly

Item No.	Description	SMALL FRAME PART NUMBERS	LARGE FRAME PART NUMBERS		Qty.
		MODELS B, C & F	MODELS J, JJ, L, & LL	MODELS R & RR	
1	SWIVEL SUSPENSION ASSEMBLY - W/ LATCH TYPE HOOK	2792NH	3661NH	3660NH	1
	SWIVEL SUSPENSION ASSEMBLY - W/ LATCHLOK TYPE HOOK	2796NH	3662NH	3663NH	
	RIGID SUSPENSION ASSEMBLY - W/ LATCH TYPE HOOK	2788NH	3651NH	3658NH	
	RIGID SUSPENSION ASSEMBLY - W/ LATCHLOK TYPE HOOK	2790NH	3652NH	-*	
1.1	SUSPENSION ADAPTER	00000218B	00000220B	00000221B	1
1.2	UPPER HOOK SUB-ASSEMBLY - LATCH TYPE	28689B	35617B	35616B	1
	UPPER HOOK SUB-ASSEMBLY - LATCHLOK TYPE	28643	36678	36680	
1.2.1	LATCH KIT	45661	45662	45663	-**
1.3	THRUST WASHER (FOR SWIVEL SUSPENSIONS ONLY)	27786	45930	45918	1
1.4	UPPER HOOK COLLAR FOR SWIVEL SUSPENSIONS	27350	35042	35041	1
	UPPER HOOK COLLAR FOR RIGID HOOK AND LUG SUSPENSIONS	27372	35458	35426	
1.5	SPRING PIN	27805	983763 for Rigid Suspension	983762	1
			983764 for Swivel Suspension		
1.6	DEAD END BOLT	-	-	35957	1
1.7	DEAD END BLOCK	-	-	35418	1
1.8	DEAD END PIN	-	-	82314	1
1.9	WASHER	-	-	987877	1
1.10	COTTER PIN	-	-	988330	1
1.11	SUSPENSION SCREW	987554	36849	36849	2

*Contact factory for Latchlok hooks and assemblies

**Latch Type hooks assemblies come with latches installed